

# IQ PANEL 5 QUICK GUIDE

## 1 WALL MOUNT

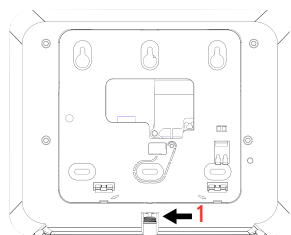

1. With a small phillips screwdriver, undo the locking screw from the back of the panel, remove the SmartMount backplate.

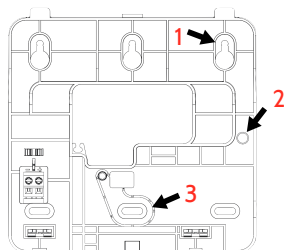

1. Mount the backplate to the wall using #6 flat head screws and appropriate wall anchors if needed, ensuring it is level.

2. A screw is required in break-away wall tamper for UL 2610.

3. Connect the power supply to the barrel jack on the back of the panel or to the (+) and (-) terminals on the backplate if using a custom length wire.

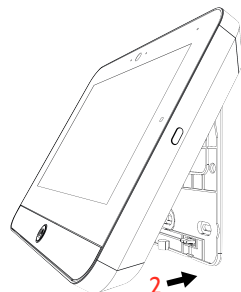

1. Latch the top of the IQ Panel 5 onto the SmartMount backplate

2. Swing the panel down towards the backplate and press firmly against the wall.

If using a custom length wire, power terminals will automatically connect and provide power to the IQ Panel.

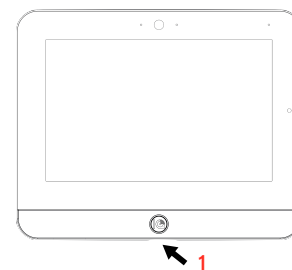

1. With a small phillips screwdriver, screw in the locking screw from the bottom of the panel to secure it to the wall.

## 2

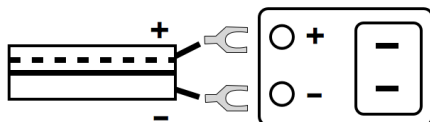

Connect power supply  
**WARNING! Use 12vDC Power Supply ONLY**

## 3



Press and hold the power button on the right side of the panel for 3 seconds to power up

## 4



CREATE ACCOUNT



TRY THE MOBILE TECH APP

## 5 ON SCREEN SETUP WIZARD (Auto Launch)

Once the panel powers up the on-screen wizard will automatically appear.

Follow the prompts to complete your installation.

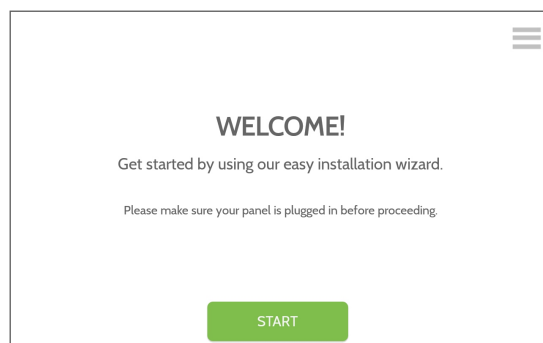

## SETUP WIZARD (Manual Launch)

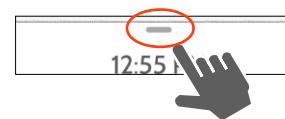

Tap to access settings tray



Settings



Advanced  
(default installer password is 1111)



Setup Wizard  
(Launch Wizard)